

T u b e S t u b

Connection Style	Hose Barb Size	Connection Size	Part Number
Tube Stub	1/8"	1/8"	FF0232
Tube Stub	1/8"	1/4"	FF0232 U
Tube Stub	1/8"	3/8"	FF0232 UU
Tube Stub	1/8"	1/2"	FF0232 UUU
Tube Stub	1/8"	8 M M	FF0232 8 M M
Tube Stub	1/8"	10 M M	FF0232 10 M M
Tube Stub	1/8"	12 M M	FF0232 12 M M
Tube Stub	1/4"	1/8"	FF0432 D
Tube Stub	1/4"	1/4"	FF0432
Tube Stub	1/4"	3/8"	FF0432 U
Tube Stub	1/4"	1/2"	FF0432 UU
Tube Stub	1/4"	8 M M	FF0432 8 M M
Tube Stub	1/4"	10 M M	FF0432 10 M M
Tube Stub	1/4"	12 M M	FF0432 12 M M
Tube Stub	3/8"	1/4"	FF0632 D
Tube Stub	3/8"	3/8"	FF0632
Tube Stub	3/8"	1/2"	FF0632 U
Tube Stub	3/8"	8 M M	FF0632 8 M M
Tube Stub	3/8"	10 M M	FF0632 10 M M
Tube Stub	3/8"	12 M M	FF0632 12 M M
Tube Stub	1/2"	3/8"	FF0832 D
Tube Stub	1/2"	1/2"	FF0832
Tube Stub	1/2"	3/4"	FF0832 U
Tube Stub	1/2"	8 M M	FF0832 8 M M
Tube Stub	1/2"	10 M M	FF0832 10 M M
Tube Stub	1/2"	12 M M	FF0832 12 M M
Tube Stub	3/4"	1/2"	FF1232 D
Tube Stub	3/4"	3/4"	FF1232
Tube Stub	3/4"	1"	FF1232 U
Tube Stub	1"	3/4"	FF1632 D
Tube Stub	1"	1"	FF1632

Part Numbering System Example: 08 BF 3210 m m 32U - 50"

Hose Size I.D.	Hose Style	Conn. Style	Conn. Style	Length
08	BF	32 10 MM	32U	50"
1/2" I.D. Hose	Teflon Lined, Stainless Steel Braided Hose	Tube Stub 10 MM	3/4" Tube Stub	4 Feet, 2 Inches

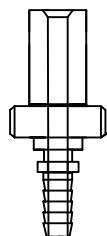

- Internal Chamfered - Allows a smooth transition between hose and fittings.
- Made with 316L Stainless Steel.
- Crimp ferrules made with 304 Stainless Steel.
- Electro-polished connection available.
- Tubing and connection has identical dimension match.

Male NPT

Connection Style	Hose Barb Size	Connection Size	Part Number
Male NPT	1/8"	1/16"	FF0203 D
Male NPT	1/8"	1/8"	FF0203
Male NPT	1/8"	1/4"	FF0203 U
Male NPT	1/8"	3/8"	FF0203 UU
Male NPT	1/8"	1/2"	FF0203 UUU
Male NPT	1/4"	1/8"	FF0403 D
Male NPT	1/4"	1/4"	FF0403
Male NPT	1/4"	3/8"	FF0403 U
Male NPT	3/8"	1/4"	FF0603 D
Male NPT	3/8"	3/8"	FF0603
Male NPT	3/8"	1/2"	FF0603 U
Male NPT	1/2"	3/8"	FF0803 D
Male NPT	1/2"	1/2"	FF0803
Male NPT	1/2"	3/4"	FF0803 U
Male NPT	3/4"	1/2"	FF1203 D
Male NPT	3/4"	3/4"	FF1203
Male NPT	3/4"	1"	FF1203 U
Male NPT	1"	3/4"	FF1603 D
Male NPT	1"	1"	FF1603
Male NPT	1 1/2"	1 1/2"	FF2403
Male NPT	2"	2"	FF3203

Part Numbering System Example: 04 BF 03D 03 - 120"

Hose Size I.D.	Hose Style	Conn. Style	Conn. Style	Length
04	BF	03D	03	120"
1/4" I.D. Hose	Teflon Lined, Stainless Steel Braided Hose	1/8" Male NPT	1/4" Male NPT	10 Feet Long

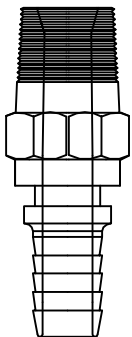

- Internal Chamfered- Allows a smooth transition between hose and fittings.
- Made with 316L Stainless Steel.
- Crimp ferrules made with 304 Stainless Steel.
- Electro-polished connection available.
- Tubing and connection has identical dimension match.

Female JIC

Connection Style	Hose Barb Size	Connection Size	Part Number
Female JIC	1/8"	1/8"	FF0202
Female JIC	1/8"	1/4"	FF0202 U
Female JIC	1/8"	3/8"	FF0202 UU
Female JIC	1/8"	1/2"	FF0202 UUU
Female JIC	1/4"	1/4"	FF0402
Female JIC	1/4"	5/16"	FF0402 SP 5
Female JIC	1/4"	3/8"	FF0402 U
Female JIC	3/8"	1/4"	FF0602 D
Female JIC	3/8"	3/8"	FF0602
Female JIC	3/8"	1/2"	FF0602 U
Female JIC	1/2"	3/8"	FF0802 D
Female JIC	1/2"	1/2"	FF0802
Female JIC	1/2"	5/8"	FF0802 SP 5
Female JIC	1/2"	3/4"	FF0802 U
Female JIC	3/4"	1/2"	FF1202 D
Female JIC	3/4"	3/4"	FF1202
Female JIC	3/4"	1"	FF1202 U
Female JIC	1"	3/4"	FF1602 D
Female JIC	1"	1"	FF1602
Female JIC	1"	1 1/4"	FF1602 U
Female JIC	1 1/2"	1 1/2"	FF2402
Female JIC	2"	1 1/2"	FF3202

Part Numbering System Example: 06 FF 02D 02U - 36"

Hose Size I.D.	Hose Style	Conn. Style	Conn. Style	Length
06	FF	02 D	02 U	36"
3/8" I.D. Hose	Teflon Lined, Fiberglass Braided Hose	1/4" Female JIC	1/2" Female JIC	3 Feet Long

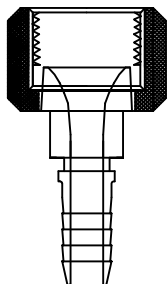

- Internal Chamfered- Allows a smooth transition between hose and fittings.
- Made with 316L Stainless Steel.
- Crimp ferrules made with 304 Stainless Steel.
- Electro-polished connection available.
- Tubing and connection has identical dimension match.

Female NPT

Connection Style	Hose Barb Size	Connection Size	Part Number
Female NPT	1/8"	1/8"	FF0206
Female NPT	1/8"	1/4"	FF0206 U
Female NPT	1/8"	3/8"	FF0206 UU
Female NPT	1/8"	1/2"	FF0206 UUU
Female NPT	1/4"	1/8"	FF0406 D
Female NPT	1/4"	1/4"	FF0406
Female NPT	1/4"	3/8"	FF0406 U
Female NPT	3/8"	1/4"	FF0606 D
Female NPT	3/8"	3/8"	FF0606
Female NPT	3/8"	1/2"	FF0606 U
Female NPT	1/2"	3/8"	FF0806 D
Female NPT	1/2"	1/2"	FF0806
Female NPT	1/2"	3/4"	FF0806 U
Female NPT	3/4"	1/2"	FF1206 D
Female NPT	3/4"	3/4"	FF1206
Female NPT	3/4"	1"	FF1206 U
Female NPT	1"	3/4"	FF1606 D
Female NPT	1"	1"	FF1606

Part Numbering System Example: 06 STF 06 06D - 12"

Hose Size I.D.	Hose Style	Conn. Style	Conn. Style	Length
06	STF	06	06D	12"
3/8" I.D. Hose	Teflon Lined, Stainless Steel Braided, Silicone Covered	3/8" Female NPT	1/4" Female NPT	1 Feet Long

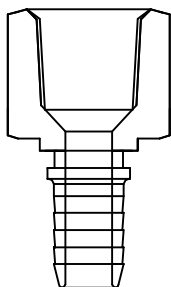

- Internal Chamfered- Allows a smooth transition between hose and fittings.
- Made with 316L Stainless Steel.
- Crimp ferrules made with 304 Stainless Steel.
- Electro-polished connection available.
- Tubing and connection has identical dimension match.

C o m p r e s s i o n

Connection Style	Hose Barb Size	Connection Size	Part Number
Compression Connection	1/8"	1/4"	FF0231 U
Compression Connection	1/8"	3/8"	FF0231 UU
Compression Connection	1/8"	1/2"	FF0231 UUU
Compression Connection	1/4"	1/4"	FF0431
Compression Connection	1/4"	3/8"	FF0431 U
Compression Connection	3/8"	1/4"	FF0631 D
Compression Connection	3/8"	3/8"	FF0631
Compression Connection	3/8"	1/2"	FF0631 U
Compression Connection	1/2"	3/8"	FF0831 D
Compression Connection	1/2"	1/2"	FF0831
Compression Connection	1/2"	3/4"	FF0831 U
Compression Connection	3/4"	1/2"	FF1231 D
Compression Connection	3/4"	3/4"	FF1231
Compression Connection	3/4"	1"	FF1231 U
Compression Connection	1"	3/4"	FF1631 D
Compression Connection	1"	1"	FF1631

Part Numbering System Example: 12 CF 31D 31 - 24"

Hose Size I.D.	Hose Style	Conn. Style	Conn. Style	Length
12	CF	31 D	31	24"
3/4" I.D. Hose	Convuluted Teflon Lined, Stainless Steel Braided	1/2" Compression	3/4" copression	2 Feet Long

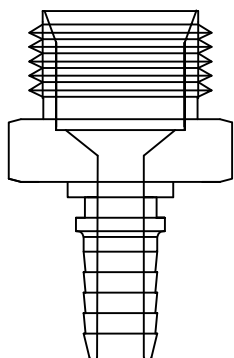

- Internal Chamfered- Allows a smooth transition between hose and fittings.
- Made with 316L Stainless Steel.
- Crimp ferrules made with 304 Stainless Steel.
- Electro-polished connection available.
- Tubing and connection has identical dimension match.